



Vigo

DV913





LINEA DIREZIONALE
EXECUTIVE LINE
SERIE EJECUTIVA
LIGNES DE DIRECTION
DIREKTIONSEINRICHTUNGSPROGRAMME
LINHA DIRECÇÃO

 **con serratura**
with lock
con cerradura
avec serrure
mit Schloss
com fechadura

 **articolo non in pronta consegna. Per la disponibilità contattare l'ufficio commerciale**
item not in prompt delivery. Please contact the commercial department for checking availability
producto no disponible en stock. Para la disponibilidad contactar con el departamento comercial
article non disponible en stock. Merci de contacter le service commercial pour vérifier la disponibilité
Dieses Produkt ist nicht sofort lieferbar. Setzen Sie sich mit unserem Handelsbüro in Verbindung für die Warenverfügbarkeit
produtos não pronta entrega. Acerca da disponibilidade, contactar o sector comercial

 **Piano intero**
Full worktop
Sobre completo
Plateau complet
Ganze Arbeitsplatte
Plano intero

 **Piano composto**
Compound worktop
Sobre compuesto
Plateau composé
Zusammengesetzte Arbeitsplatte
Plano composto

 **Posizione seduta**
Chair position
Posición asiento
Position siège
Stuhl Position
Posición asiento

V01 Piani di lavoro in melaminico sp. 50 mm
 Melamine worktops 50 mm thick
 Sobres de trabajo en melamina 50 mm de grosor
 Plans de travail en mélaminé ép. 50 mm
 Tischplatten aus Melamin St. 50 mm
 Planos de trabalho em melaminico esp. 50 mm



RC
 Rovere chiaro
 Light oak
 Roble claro
 Chêne clair
 Eiche hell
 Carvalho claro



NM
 Noce "Maroncelli"
 Walnut "Maroncelli"
 Nogal "Maroncelli"
 Noyer "Maroncelli"
 Nussbaum "Maroncelli"
 Nogueira "Maroncelli"

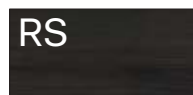

RS
 Rovere scuro
 Dark oak
 Roble oscuro
 Chêne foncé
 Eiche dunkel
 Carvalho escuro

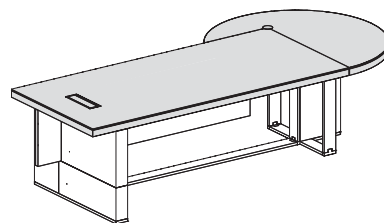

V01 PIANO COMPOSTO - Piani di lavoro in melaminico sp. 10 mm
 COMPOUND WORKTOP - Melamine worktops 50 mm thick
 SOBRE COMPUESTO - Sobres de trabajo en melamina 50 mm de grosor
 PLATEAU COMPOSÉ - Plans de travail en mélaminé ép. 50 mm
 ZUSAMMENGESETZTE ARBEITSPLATTE - Tischplatten aus Melamin St. 50 mm
 PLANO COMPOSTO - Planos de trabalho em melaminico esp. 50 mm



RC
 Rovere chiaro
 Light oak
 Roble claro
 Chêne clair
 Eiche hell
 Carvalho claro



NM
 Noce "Maroncelli"
 Walnut "Maroncelli"
 Nogal "Maroncelli"
 Noyer "Maroncelli"
 Nussbaum "Maroncelli"
 Nogueira "Maroncelli"



RS
 Rovere scuro
 Dark oak
 Roble oscuro
 Chêne foncé
 Eiche dunkel
 Carvalho escuro

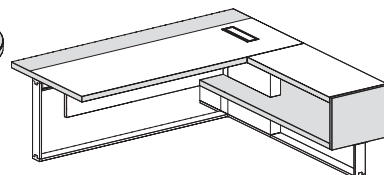
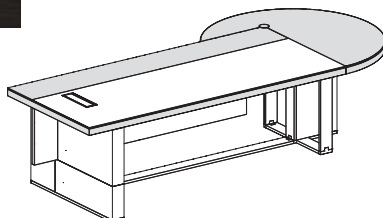

V01 PIANO COMPOSTO - Piani in vetro temprato serigrafato, con superficie acidata, sp. 10 mm
 COMPOUND WORKTOP - Worktops with tempered silkscreen glass with acetated surface, 10 mm thick
 SOBRE COMPUESTO - Sobre de trabajo en cristal templado serigrafiado al acido, de 10 mm de grosor
 PLATEAU COMPOSÉ - Plans de travail en verre trempé sérigraphié avec surface acidée, ép. 10 mm
 ZUSAMMENGESETZTE ARBEITSPLATTE - Tischplatten aus
 PLANO COMPOSTO - Planos de trabalho en



VSB
 Bianco
 White
 Blanco
 Blanc
 Weiß
 Branco



VSN
 Nero
 Black
 Negro
 Noir
 Schwarz
 Preto

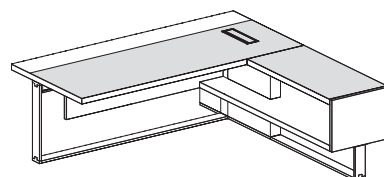
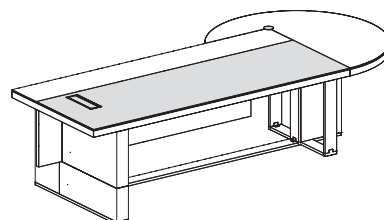

Lo sportello del top-access è rivestito nella stessa finitura del piano scrivania in melaminico o in vetro serigrafato.

The flip door of the top access is coated in the same finish as the melamine worktop or in silkscreen glass.
 La tapa del top access esta revestida con el mismo acabado del sobre de trabajo en melamina o en cristal serigrafiado.
 Le clapet du top access est réalisé avec un revêtement dans la même finition du plateau en mélaminé ou en verre sérigraphié.
 Die Arbeitsplatten von allen Tischen sind mit Kabeldurchlass mit Klapp Tür ausgestattet, mit passender Oberfläche zur Schreibtischplatte oder Glas mit Serigraphie.
 A portinhola do top-access é revestida no mesmo acabamento do tampo da secretária em melamina ou, em vidro serigrafado.

	RC Rovere chiaro Light oak Roble claro Chêne clair Eiche hell Carvalho claro	NM Noce "Maroncelli" Walnut "Maroncelli" Nogal "Maroncelli" Noyer "Maroncelli" Nussbaum "Maroncelli" Nogueira "Maroncelli"	RS Rovere scuro Dark oak Roble oscuro Chêne foncé Eiche dunkel Carvalho escuro		VSB Bianco White Blanco Blanc Weiß Branco	VSN Nero Black Negro Noir Schwarz Preto

DV913 Vigo

Finiture - finishes - acabados - finitions - farben - acabamentos

V02 **Strutture metalliche**
 Metal structures
 Estructuras metálicas
 Structures métalliques
 Metallstrukturen
 Estruturas metálicas



Bianco
 White
 Blanco
 Blanc
 Weiß
 Branco



Alluminio
 Aluminium
 Aluminio
 Aluminium
 Aluminium
 Aluminio



Antracite
 Anthracite
 Antracita
 Anthracite
 Anthrazit
 Antracite

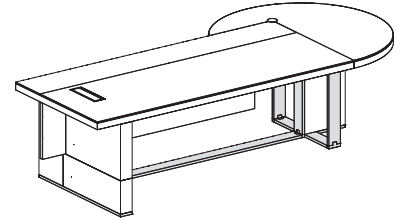

V07 M1 **Gambe pannellate in folding sp. 18 mm**
 Folding legs 18 mm thick
 Patas paneladas en folding 18 mm de grosor
 Pieds panneaux en folding ép. 18 mm
 Wangenfuß aus Folding St. 18 mm
 Pernas em painel en folding esp. 18 mm



Rovere chiaro
 Light oak
 Roble claro
 Chêne clair
 Eiche hell
 Carvalho claro



Noce "Maroncelli"
 Walnut "Maroncelli"
 Nogal "Maroncelli"
 Noyer "Maroncelli"
 Nussbaum "Maroncelli"
 Nogueira "Maroncelli"

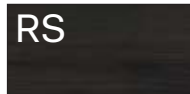

Rovere scuro
 Dark oak
 Roble oscuro
 Chêne foncé
 Eiche dunkel
 Carvalho escuro



Nero opaco
 Matt black
 Negro mate
 Noir mat
 Schwarz matt
 Preto opaco

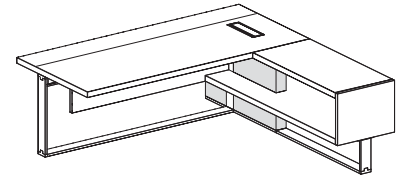

Modesty panel
 Modesty panel
 Faldón
 Voile de fond
 Knieblende
 Modesty panel



Rovere chiaro
 Light oak
 Roble claro
 Chêne clair
 Eiche hell
 Carvalho claro



Noce "Maroncelli"
 Walnut "Maroncelli"
 Nogal "Maroncelli"
 Noyer "Maroncelli"
 Nussbaum "Maroncelli"
 Nogueira "Maroncelli"

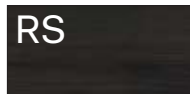

Rovere scuro
 Dark oak
 Roble oscuro
 Chêne foncé
 Eiche dunkel
 Carvalho escuro

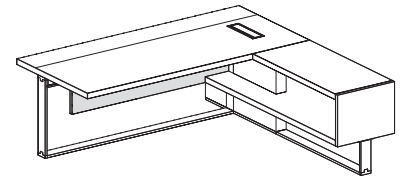

Top access Alluminio
 Top access Aluminium
 Top access Aluminio
 Top access Aluminium
 Top Access Aluminium
 Top access Aluminio

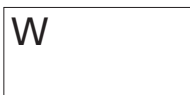

Bianco
 White
 Blanco
 Blanc
 Weiss
 Branco



Alluminio
 Aluminium
 Aluminio
 Aluminium
 Aluminium
 Aluminio



Nero anodizzato
 Anodized black
 Negro anodizado
 Noir anodisé
 eloxiert Schwarz
 Preto anodizado

V81

Allungo laterale / Allungo a giorno - LATO SINISTRO (SX) o LATO DESTRO (DX)

Lateral extension / Open extension - LEFT HAND (SX) or RIGHT HAND (DX)
 Alargo lateral / Ala auxiliar abierta - LADO IZQUIERDO (SX) o LADO DERECHO (DX)
 Retour latéral / Retour à jour - CÔTÉ GAUCHE (SX) ou CÔTÉ DROITE (DX)
 Seitlicher Verlängerungplatte / Offenem Beistellmöbel - LINKS (SX) oder RECHT (DX)
 Mesa auxiliar datilo lateral / Sobre extensão aberta - LATERAL ISQUIERDA (SX) ou LATERAL DIREITO (DX)

913.TS.61._

913.TS.62._

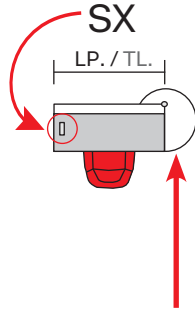

ATTENZIONE! PENISOLA DESTRA

WARNING! Peninsula RIGHT HAND
 ¡ADVERTENCIA! Península LADO DERECHO
 ATTENTION! Plan convivialité CÔTÉ DROITE
 ACHTUNG! Halbinsel für Schreibtisch RECHT
 ATENÇÃO! Península LATERAL DIREITO

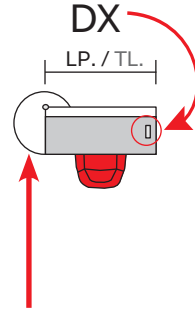

ATTENZIONE! PENISOLA SINISTRA

WARNING! Peninsula LEFT HAND
 ¡ADVERTENCIA! Península LADO IZQUIERDO
 ATTENTION! Plan convivialité CÔTÉ GAUCHE
 ACHTUNG! Halbinsel für Schreibtisch LINKS
 ATENÇÃO! Península LATERAL ISQUIERDA

913.TM.36._

913.TM.37._

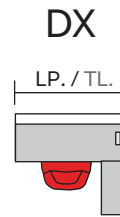
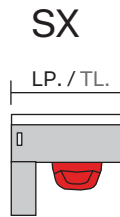

913.TM.46._

913.TM.47._

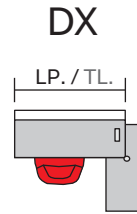
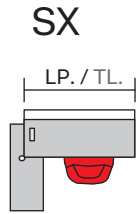

SCHEMA DIMENSIONALE - Esempi di composizione con penisola

DIMENSIONAL DIAGRAM - Examples of compositions with peninsula
 TABLA DIMENSIONAL - Ejemplos de composiciones con península
 SCHEMA DIMENSIONNEL - Exemples de composition avec plan convivialité
 MABSCHEMA - Beispiel von Komposition mit Halbinsel
 ESQUEMA DIMENSIONAL - Exemplos de composições com península

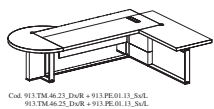

Cod. 913.TM.46.22.Dx/R + 913.PE.01.13.Sx/L
 913.TM.46.22.Dx/R + 913.PE.01.13.Sx/L

L/W	295 cm - 116 2/16"	315 cm - 124"
Ld/Wd	200 cm - 78 6/8"	220 cm - 86 5/8"

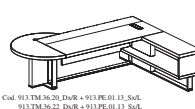
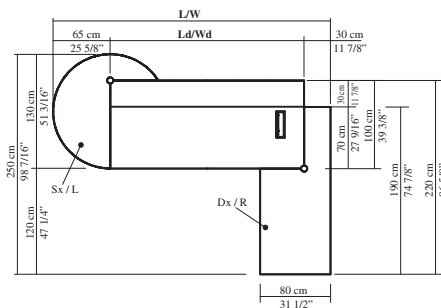

Cod. 913.TM.36.20.Dx/R + 913.PE.01.13.Sx/L
 913.TM.36.22.Dx/R + 913.PE.01.13.Sx/L

L/W	265 cm - 104 5/16"	285 cm - 112 4/16"
Ld/Wd	200 cm - 78 6/8"	220 cm - 86 5/8"

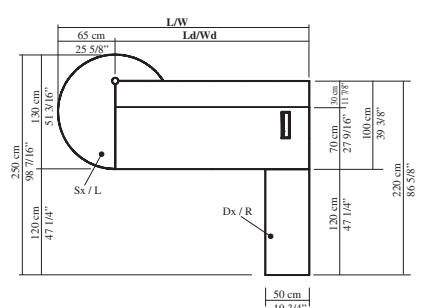

DV913 Vigo

Finiture - finishes - acabados - finitions - farben - acabamentos

V04 **LIBRERIA - Scocche in melaminico sp. 30/50 mm**
 BOOKSHELF - Melamine bodies 30/50 mm thick
 ESTANTE - Cuerpos en melamina 30/50 mm de grosor
 ÉTAGÈRE - Coffres en melaminé ép. 30/50 mm
 BÜCHERREGAL - Korpus aus Melamin St. 30/50 mm
 ESTANTE - Corpo en melaminico esp. 30/50 mm



RC
 Rovere chiaro
 Light oak
 Roble claro
 Chêne clair
 Eiche hell
 Carvalho claro



NM
 Noce "Maroncelli"
 Walnut "Maroncelli"
 Nogal "Maroncelli"
 Noyer "Maroncelli"
 Nussbaum "Maroncelli"
 Nogueira "Maroncelli"

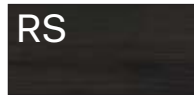

RS
 Rovere scuro
 Dark oak
 Roble oscuro
 Chêne foncé
 Eiche dunkel
 Carvalho escuro

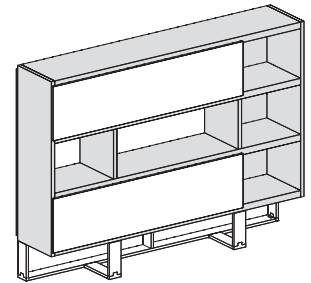

V05 M1 **LIBRERIA - Ante / schiene in melaminico sp. 18 mm**
 BOOKSHELF - Melamine doors / back panels 18 mm thick
 ESTANTE - Puertas / traseras en melamina 18 mm de grosor
 ÉTAGÈRE - Portes / dos en melaminé ép. 18 mm
 BÜCHERREGAL - Türen / Rueckwand aus Melamin St. 18 mm
 ESTANTE - Portas / fundo en melaminico esp. 18 mm



RC
 Rovere chiaro
 Light oak
 Roble claro
 Chêne clair
 Eiche hell
 Carvalho claro



NM
 Noce "Maroncelli"
 Walnut "Maroncelli"
 Nogal "Maroncelli"
 Noyer "Maroncelli"
 Nussbaum "Maroncelli"
 Nogueira "Maroncelli"

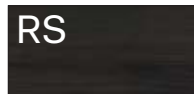

RS
 Rovere scuro
 Dark oak
 Roble oscuro
 Chêne foncé
 Eiche dunkel
 Carvalho escuro

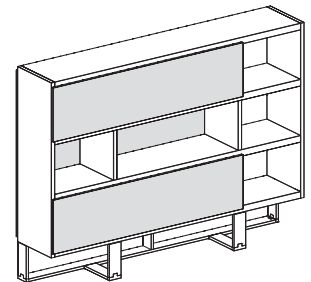

V05 M2 **NO**

NO
 Nero opaco
 Matt black
 Negro mate
 Noir mat
 Schwarz matt
 Preto opaco

V02 **LIBRERIA - Strutture metalliche**
 BOOKSHELF - Metal structures
 ESTANTE - Estructuras metálicas
 ÉTAGÈRE - Structures métalliques
 BÜCHERREGAL - Metallstrukturen
 ESTANTE - Estructuras metálicas



W
 Bianco
 White
 Blanco
 Blanc
 Weiß
 Branco



H
 Alluminio
 Aluminium
 Aluminio
 Aluminium
 Aluminium
 Aluminio



A
 Antracite
 Anthracite
 Antracita
 Anthracite
 Anthrazit
 Antracite

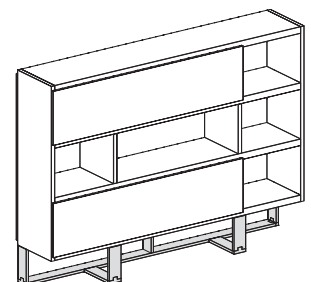

DV913 Vigo

Come ordinare - How to order

CODICE CODE	L. W.	P. D.	H. H.
913.TS.62.28	285 112 1/4"	130 51 1/4"	76 30"

Tavolo scrivania con piano composto e penisola

Table desk with composed top and peninsula

Mesa despacho con plano compuesto y con península

Bureau avec plateau composé et avec plan convivialité

Schreibtisch mit Arbeitsplattenkombination und mit Halbinsel

Mesa escritivaninha com plano componível e com península

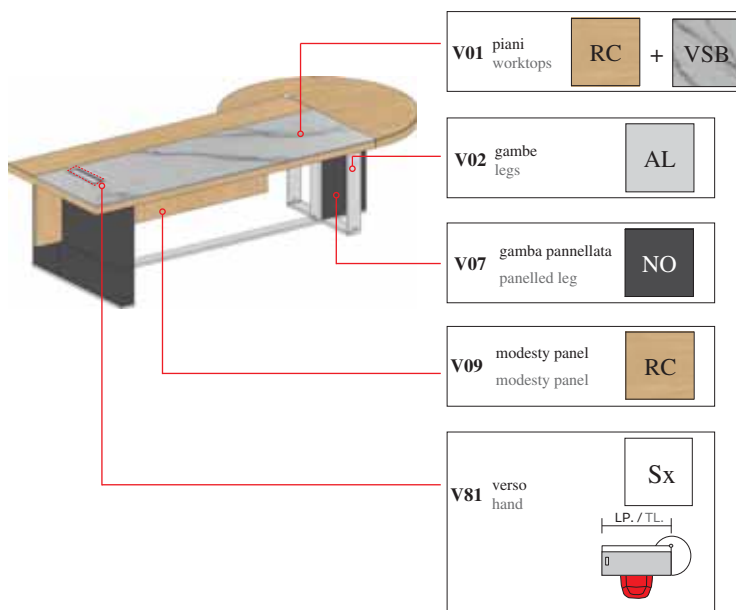

PREZZO
PRICE

V2

PREZZO
PRICE

€ 5.687

CODICE CODE	L. W.	P. D.	H. H.
913.CL.RL.20	215 84 3/4"	45 17 3/4"	158 62 1/4"

Libreria con ante a ribalta

Bookcase with flap doors

Estanteria con puertas abatibles

Bibliothèque avec portes a abattantes

Buercherregal mit Klapptüren

Estante com porta de abertura horizontal

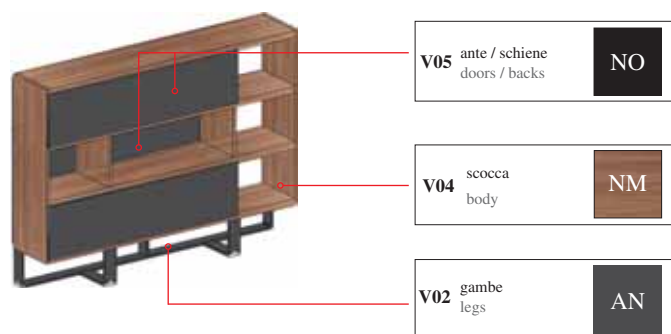

PREZZO
PRICE

M2

PREZZO
PRICE

€ 3.534

CODICE CODE	L. W.	P. D.	H. H.
913.TM.37.20	200 78 3/4"	220 86 5/8"	76 30"

Tavoli con piano composto e con allungo a giorno

Tables with composed worktop and open extension

Mesa despacho con plano compuesto y con ala auxiliar abierta

Bureau avec plateau composé et avec retour à jour

Schreibtisch mit Arbeitsplattenkombination und mit offenem Beistellmöbel

Mesa escritivaninha com plano componível e com sobre extensão aberta

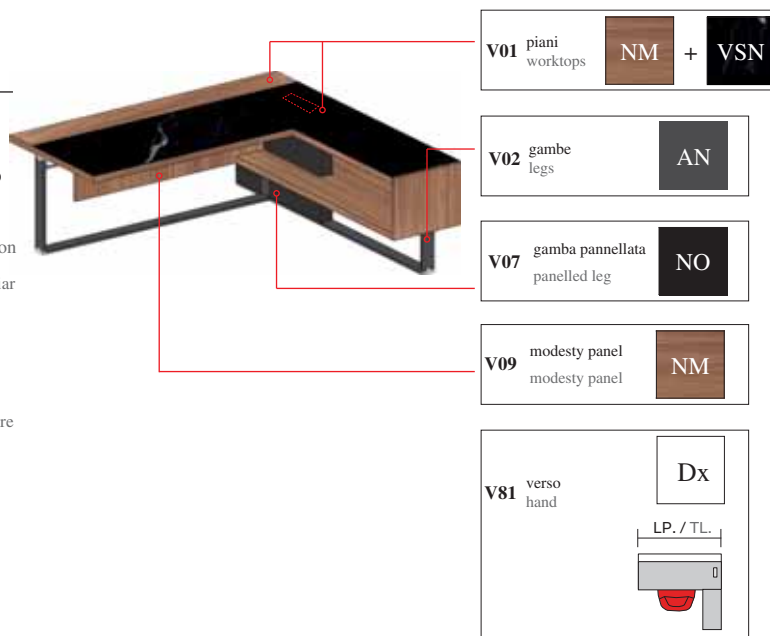

PREZZO
PRICE

V2

PREZZO
PRICE

€ 5.310

DV913 Vigo

M1	V01 piani worktops	RC	NM	RS
	V02 gambe legs	W	H	A
	V07 gamba pannellata panelled leg	RC	NM	RS
	V09 modesty panel modesty panel	RC	NM	RS
	V81 verso hand	Sx	Dx	

M2	V01 piani worktops	RC	NM	RS
	V02 gambe legs	W	H	A
	V07 gamba pannellata panelled leg	NO		
	V09 modesty panel modesty panel	RC	NM	RS
	V81 verso hand	Sx	Dx	

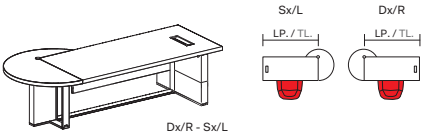
SCRIVANIE DESKS	LP. TL.	L. W.	P. D.	H. H.	CODICE CODE	CATEGORIA PREZZO / PRICE CATEGORY		Kg. lb	m³ ft³	n. no.	
						M1	M2				
 <p>Tavolo scrivania con penisola</p> <p>Table desk with peninsula</p> <p>Mesa despacho con península</p> <p>Bureau avec plan convivialité</p> <p>Schreibtisch mit Halbinsel</p> <p>Mesa escritivaninha com península</p>	200 78 3/4"	265 104 3/8"	130 51 1/4"	75 29 5/8"	913.TS.61.26	3.785	3.856	169,95 374,73	0,597 21,09	17 17	
	220 86 1/2"	285 112 1/4"	130 51 1/4"	75 29 5/8"	913.TS.61.28	3.843	3.914	180,85 398,77	0,617 21,80	17 17	
						<p>1 Top access incluso 1 Top access included 1 Top access incluido 1 Top access inclus 1 Top Access Inbegriffen 1 Top access incluso</p> <p>L.30 cm - W. 11 3/4"</p>					

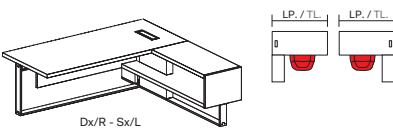
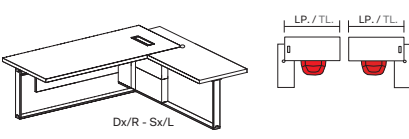
SCRIVANIE CON ALLUNGHI DESKS WITH LATERAL SIDE	LP. TL.	L. W.	P. D.	H. H.	CODICE CODE	CATEGORIA PREZZO / PRICE CATEGORY		Kg. lb	m³ ft³	n. no.	
						M1	M2				
 <p>Tavolo scrivania con allungo a giorno</p> <p>Table desk with open extension</p> <p>Mesa despacho con ala auxiliar abierta</p> <p>Bureau avec retour à jour</p> <p>Schreibtisch mit offenem Beistellmöbel</p> <p>Mesa escritivaninha com sobre extensão aberta</p>	200 78 3/4"	200 78 3/4"	220 86 5/8"	75 29 5/8"	913.TM.36.20	3.227	3.282	193,10 425,78	0,512 18,09	18 18	
	220 86 1/2"	220 86 5/8"	220 86 5/8"	75 29 5/8"	913.TM.36.22	3.285	3.340	204,00 449,82	0,532 18,79	18 18	
						<p>1 Top access incluso 1 Top access included 1 Top access incluido 1 Top access inclus 1 Top Access Inbegriffen 1 Top access incluso</p> <p>L.30 cm - W. 11 3/4"</p>					
 <p>Tavolo scrivania con allungo laterale</p> <p>Tables with lateral extension</p> <p>Mesa despacho con alargó lateral</p> <p>Bureau avec retour latéral</p> <p>Schreibtische mit seitlicher Verlängerungplatte</p> <p>Mesa escritivaninha com mesa auxiliar datilo lateral</p>	200 78 3/4"	230 90 1/2"	220 86 5/8"	75 29 5/8"	913.TM.46.23	3.394	3.448	178,80 394,25	0,546 19,29	17 17	
	220 86 1/2"	250 98 1/2"	220 86 5/8"	75 29 5/8"	913.TM.46.25	3.452	3.506	189,70 418,28	0,566 20,00	17 17	
						<p>1 Top access incluso 1 Top access included 1 Top access incluido 1 Top access inclus 1 Top Access Inbegriffen 1 Top access incluso</p> <p>L.30 cm - W. 11 3/4"</p>					

DV913 Vigo

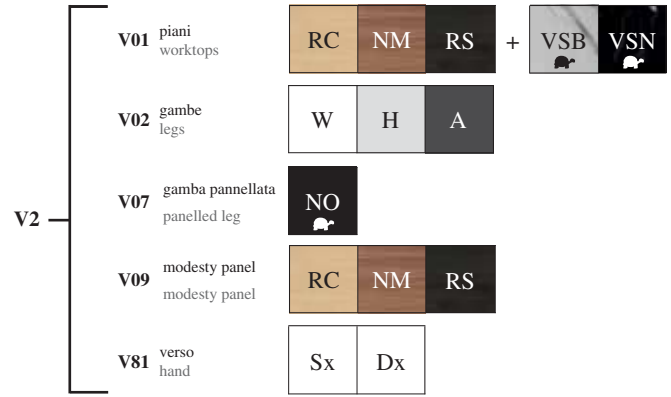
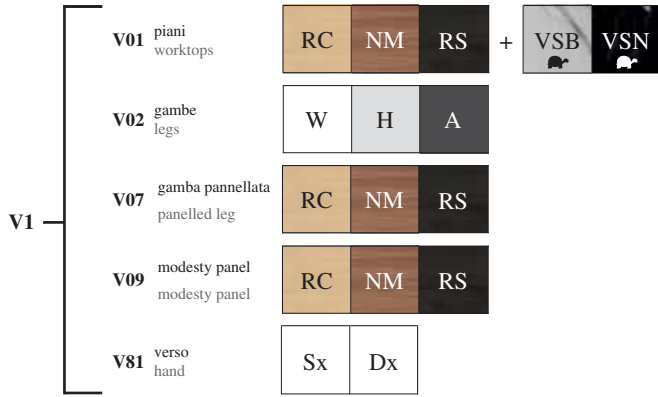

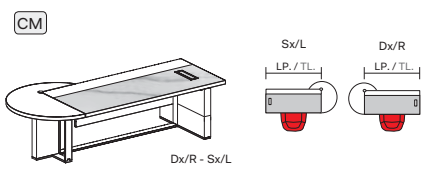
SCRIVANIE COMPOSTE COMPOUND DESKS	LP. TL.	L. W.	P. D.	H. H.	CODICE CODE	CATEGORIA PREZZO / PRICE CATEGORY		Kg. lb	m ³ ft ³	n. no.
						V1	V2			
 <p>Tavolo scrivania con piano composto e penisola</p> <p>Table desk with composed top and peninsula</p> <p>Mesa despacho con plano compuesto y con península</p> <p>Bureau avec plateau composé et avec plan convivialité</p> <p>Schreibtisch mit Arbeitsplattenkombination und mit Halbinsel</p> <p>Mesa escritivaninha com plano componível e com península</p>	200 78 3/4"	265 104 3/8"	130 51 1/4"	76 30"	913.TS.62.26	5.425	5.496	216,65 477,71	0,801 28,30	20 20
	220 86 1/2"	285 112 1/4"	130 51 1/4"	76 30"	913.TS.62.28	5.616	5.687	230,55 508,36	0,854 30,17	20 20
						<p>1 Top access incluso 1 Top access included 1 Top access incluido 1 Top access inclus 1 Top Access Inbegriffen 1 Top access incluso</p> <p>L.30 cm - W. 11 3/4"</p>				

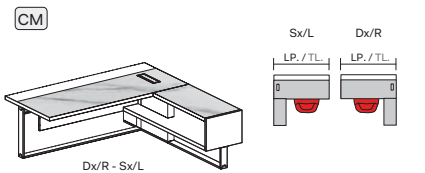
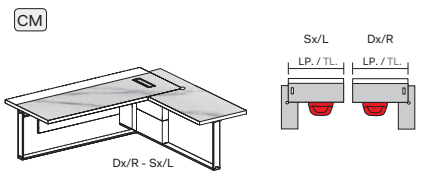
SCRIVANIE COMPOSTE CON ALLUNGI COMPOUND DESKS WITH LATERAL SIDE	LP. TL.	L. W.	P. D.	H. H.	CODICE CODE	CATEGORIA PREZZO / PRICE CATEGORY		Kg. lb	m ³ ft ³	n. no.
						V1	V2			
 <p>Tavoli con piano composto e con allungo a giorno</p> <p>Tables with composed worktop and open extension</p> <p>Mesa despacho con plano compuesto y con ala auxiliar abierta</p> <p>Bureau avec plateau composé et avec retour à jour</p> <p>Schreibtisch mit Arbeitsplattenkombination und mit offenem Beistellmöbel</p> <p>Mesa escritivaninha com plano componível e com sobre extensão aberta</p>	200 78 3/4"	200 78 3/4"	220 86 5/8"	76 30"	913.TM.37.20	5.255	5.310	249,50 550,14	0,719 25,40	21 21
	220 86 1/2"	220 86 5/8"	220 86 5/8"	76 30"	913.TM.37.22	5.446	5.501	263,40 580,79	0,772 27,27	21 21
						<p>1 Top access incluso 1 Top access included 1 Top access incluido 1 Top access inclus 1 Top Access Inbegriffen 1 Top access incluso</p> <p>L.30 cm - W. 11 3/4"</p>				
 <p>Tavoli con piano composto e con allungo laterale</p> <p>Tables with composed worktop and with lateral extension</p> <p>Mesa despacho con plano compuesto y con alargó lateral</p> <p>Bureau avec plateau composé et avec retour latéral</p> <p>Schreibtische mit Arbeitsplattenkombination und mit seitlicher Verlängerungsplatte</p> <p>Mesa escritivaninha com plano componível e com mesa auxiliar datilo lateral</p>	200 78 3/4"	230 90 1/2"	220 86 5/8"	76 30"	913.TM.47.23	6.144	6.198	254,70 561,61	0,830 29,32	20 20
	220 86 1/2"	250 98 1/2"	220 86 5/8"	76 30"	913.TM.47.25	6.335	6.389	268,60 592,26	0,883 31,20	20 20
						<p>1 Top access incluso 1 Top access included 1 Top access incluido 1 Top access inclus 1 Top Access Inbegriffen 1 Top access incluso</p> <p>L.30 cm - W. 11 3/4"</p>				

DV913
VIGO

M1	V01 piani worktops	RC	NM	RS
	V02 gambe legs	W	H	A
	V07 gamba pannellata panelled leg	RC	NM	RS
	V81 verso hand	Sx	Dx	

M2	V01 piani worktops	RC	NM	RS
	V02 gambe legs	W	H	A
	V07 gamba pannellata panelled leg	NO		
	V81 verso hand	Sx	Dx	

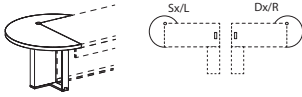
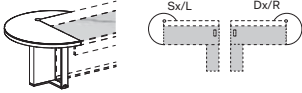
PENISOLA PENINSULA	L. W.	P. D.	H. H.	CODICE CODE	CATEGORIA PREZZO / PRICE CATEGORY		Kg. lb	m ³ ft ³	n. no.	
					M1	M2				
 <p>Penisola per scrivanie con piano unico in melaminico Peninsula for desks with unique melamine top Península para mesas con sobre único en melamina Plan convivialité pour bureau avec plateau unique en mélamine Halbinsel für Schreibtisch mit Einzelne Arbeitsfläche aus Melamin Península para mesa escritivaninha com plano unico em melamina</p>	*	130 51 1/4"	130 51 1/4"	75 29 5/8"	913.PE.01.13	1.382	1.399	45,75 100,87	0,192 6,78	5 5
 <p>Penisola per scrivania con piano composto Peninsula for desks with composed top Península para mesa despacho con plano compuesto Plan convivialité pour bureau avec plateau composé Halbinsel für Schreibtisch mit Arbeitsplattenkombination Península para mesa escritivaninha com plano componível</p>	*	130 51 1/4"	130 51 1/4"	76 30"	913.PE.02.13	1.607	1.624	52,55 115,87	0,247 8,72	6 6

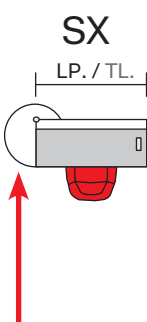

SX
LP. / TL.

ATTENZIONE! PENISOLA SINISTRA
 WARNING! Peninsula LEFT HAND
 ¡ADVERTENCIA! Península LADO IZQUIERDO
 ATTENTION! Plan convivialité CÔTÉ GAUCHE
 ACHTUNG! Halbinsel für Schreibtisch LINKS
 ATENÇÃO! Península LATERAL ISQUIERDA

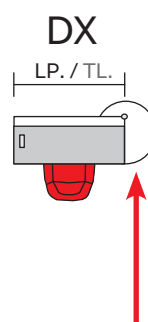

DX
LP. / TL.

ATTENZIONE! PENISOLA DESTRA
 WARNING! Peninsula RIGHT HAND
 ¡ADVERTENCIA! Península LADO DERECHO
 ATTENTION! Plan convivialité CÔTÉ DROITE
 ACHTUNG! Halbinsel für Schreibtisch RECHT
 ATENÇÃO! Península LATERAL DIREITO

V04 scocca / frontale
body / front

RC NM RS

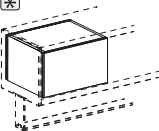
CASSETTIERA PEDESTAL	L. W.	P. D.	H. H.	CODICE CODE	V04	Kg. lb	m ³ ft ³	n. no.
 <p>Cassetiera per allungo a giorno</p> <p>Pedestal for open side extension</p> <p>Cajonera para ala auxiliar abierta</p> <p>Caisson pour retour jour</p> <p>Schubkastenblock für Beistellmöbel</p> <p>Bloco de gavetas para extensão aberta</p>	60 23 5/8"	50 19 3/4"	36,5 14 3/8"	913.MC.02.06	308	16,80 37,04	0,150 5,30	1 1



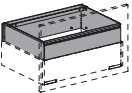

reggiartella frame	HH
-----------------------	----

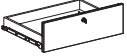
ACCESSORI PER CASSETTIERA ACCESSORIES FOR PEDESTAL	L. W.	P. D.	H. H.	CODICE CODE	PREZZO PRICE	Kg. lb	m ³ ft ³	n. no.
 <p>Reggiartella per cassetto</p> <p>Frame for folders for drawers</p> <p>Portacarpetas para cajonera</p> <p>Porte-dossiers pour caisson</p> <p>Hängeregister für Schubkastenblock</p> <p>Porta-pastas para gaveta</p>	55 21 3/4"	40 15 3/4"	8 3 1/4"	913.CA.S6.08	130	4,50 9,92	0,002 0,07	1 1

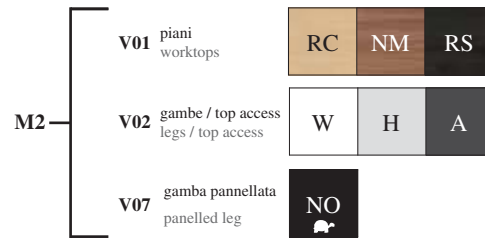
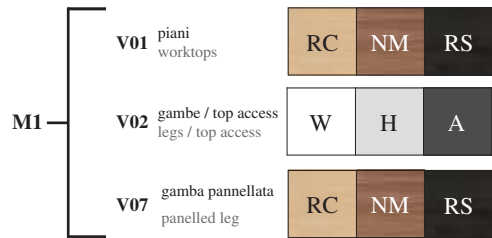
cassetto drawer	HH
--------------------	----

ACCESSORI PER CASSETTIERA ACCESSORIES FOR PEDESTAL	L. W.	P. D.	H. H.	CODICE CODE	PREZZO PRICE	Kg. lb	m ³ ft ³	n. no.
 <p>Cassetto optional per cassetiera</p> <p>Optional drawer for pedestal</p> <p>Cajon opcional para cajonera</p> <p>Tiroir en option pour caisson</p> <p>Schublade Optional für Schubkastenblock</p> <p>Gaveta opcional para gaveta</p>	56 22 1/8"	41 16 1/4"	11 4 3/8"	913.CS.01.05	85	3,00 6,61	0,041 1,44	1 1

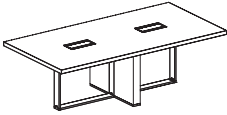

TAVOLI RIUNIONE MEETING TABLES	L. W.	P. D.	H. H.	CODICE CODE	CATEGORIA PREZZO / PRICE CATEGORY		Kg. lb	m ³ ft ³	n. no.
					M1	M2			
 <p>Tavolo riunioni circolare Round meeting table Mesa reunión circular Table réunion ronde Runder Besprechungstisch Mesa de reuniões circular</p>	140 55 1/2"	140 55 1/8"	75 29 5/8"	913.TR.11.14	2.135	2.185	88,40 194,92	0,281 9,92	7 7
						 <p>1 Top access incluso 1 Top access included 1 Top access incluido 1 Top access compris 1 Top Access Inbegriffen 1 Top access incluso Cod. 300.AC.20.03 L.34,5 cm - W. 13 1/2"</p>			
 <p>Tavolo riunioni rettangolare Rectangular meeting table Mesas reuniones rectangulares Table de réunion rectangulaire Rechteckige Besprechungstische Mesa de reuniões retangulares</p>	240 94 1/2"	120 47 1/4"	75 29 5/8"	913.TR.41.24	2.495	2.545	140,90 310,68	0,373 13,18	8 8
						 <p>2 Top access inclusi 2 Top access included 2 Top access incluidos 2 Top access compris 2 Top Access Inbegriffen 2 Top access incluso Cod. 300.AC.20.03 L.34,5 cm - W. 13 1/2"</p>			

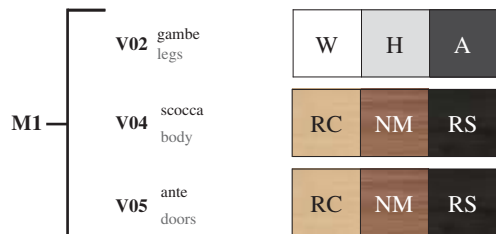

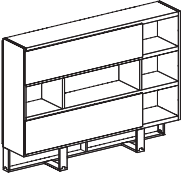
LIBRERIA BOOKSHELF	L. W.	P. D.	H. H.	CODICE CODE	CATEGORIA PREZZO / PRICE CATEGORY		Kg. lb	m ³ ft ³	n. no.
					M1	M2			
 <p>Libreria con ante a ribalta Bookcase with flap doors Estanteria con puertas abatibles Bibliothèque avec portes a abattantes Buercherregal mit Klapptueren Estante com porta de abertura horizontal</p>	215 84 3/4"	45 17 3/4"	158 62 1/4"	913.CL.RL.20	3.373	3.534	234,80 517,73	0,532 18,79	14 14
						